

ISOLED[®]

CUSTOMISED LIGHT SOLUTIONS

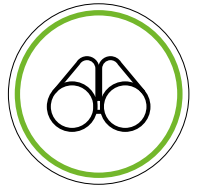

INDUSTRY FOCUS

YOUR ASSISTANT FOR ACHIEVING JUST
THE RIGHT APPEAL FOR YOUR BUSINESS

OFFICE LIGHTING





TABLE OF CONTENTS

3	Office lighting	18	ISOLED® Technology
4	Your added value with ISOLED®!	20	UGR Unified Glare Rating
5	Requirements for LED office lighting	22	Sustainable increase in efficiency with Daylight and motion sensors
6	Why LED?	24	Product quality and design
7	Product range	26	Advantage through know-how
8	ISOLED® Catalog	27	Much more than "just a webshop"
10	Customer-specific manufacturing	29	Product catalog diversity
14	Discover the ISOLED® product worlds	30	Online portal

PRODUCT RANGE



9 LED panels



11 LED tubes and Diffuser luminaires



12 LED Pendant and Floor lamps



13 Modular & configurable LED light line system



15 LED emergency light/escape route luminaires



16 LED downlights

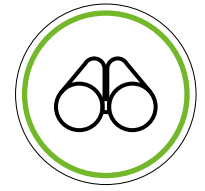

OFFICE LIGHTING

Workplace is living space

A study conducted by the market research institute Ipsos in February 2011 states that 80% of all employees cite "general well-being in the office" as both the decisive and the most important criterion when evaluating their workplace.

Creative thinking and goal-oriented control tasks are carried out in offices on a daily basis.

The human eye is exposed to large amounts of visual stimuli. Good lighting that is adapted to the tasks helps to withstand these stimuli as harmlessly as possible and to maintain physical and mental well-being.

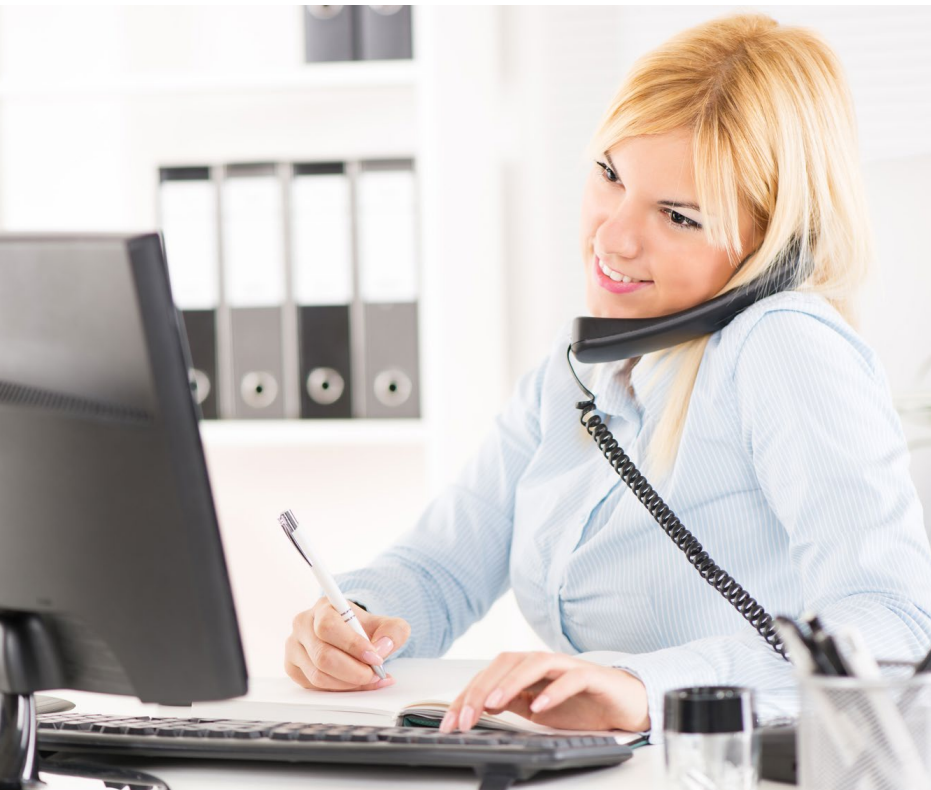

Increased productivity with LED lighting quality

Poor light makes you tired, leads to concentration problems and causes eye and headaches. Employees are absent, and the error rate increases while productivity decreases. Employees must be given a

- activating,
- motivational,
- ergonomic and
- secure environment

be made available for the work.

The fact that the quantity and quality of light required at the workplace is strictly regulated by the Occupational Health and Safety Act is further proof of how seriously the issue of correct office lighting needs to be taken.

People-oriented LED office lighting increases the attractiveness of the workplace and is a direct value-adding factor for the employer. Optimally designed office lighting promotes productivity, elevates performance, increases effectiveness, is vitalizing and boosts motivation, reduces accidents at work and sick leave, drives ideas and creativity processes and ultimately leads to sustainable cost savings.

YOUR ADDED VALUE WITH ISOLED®!



Standardised Product range

- More than 3,050 products
- High-end LED components
- High product availability

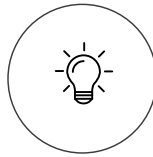

Intelligent project lighting solutions

- Scalable LED control technology
- Holistic LED lighting systems
- Personal project support

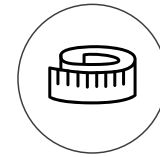

Customer-specific Manufacture

- Manufactured light elements
- Precise custom production
- Delivery ready for installation

CUSTOMISED LIGHT SOLUTIONS

SUSTAINABLE EFFICIENCY IMPROVEMENT
WITH SMART LED LIGHTING CONCEPTS

We are a full-range LED supplier for individual lighting concepts and orient ourselves in the design of our wide product range to both the

- Requirements of our customers as well as on the
- technical progress of LED technology.

Excellent quality, high consulting competence of our employees as well as sustainable growth of our company ensure a reliable and long-term demand coverage with innovative LED lighting solutions for our partners.

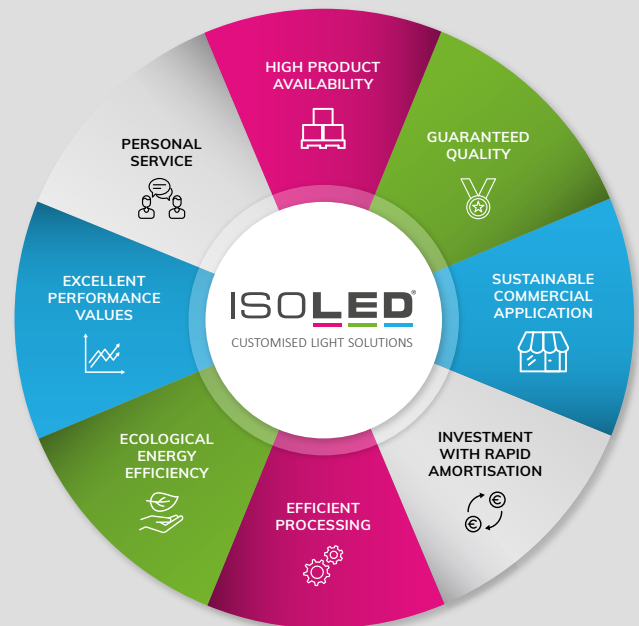

99,3 %

OF OUR CUSTOMERS RECOMMEND ISOLED® TO OTHERS!

#1 SUCCESS FACTORS
COMPETENT CUSTOMER SERVICE
PERSONAL SERVICE

We advise you!

We develop and plan your individual solution together with you.

We realize your project!



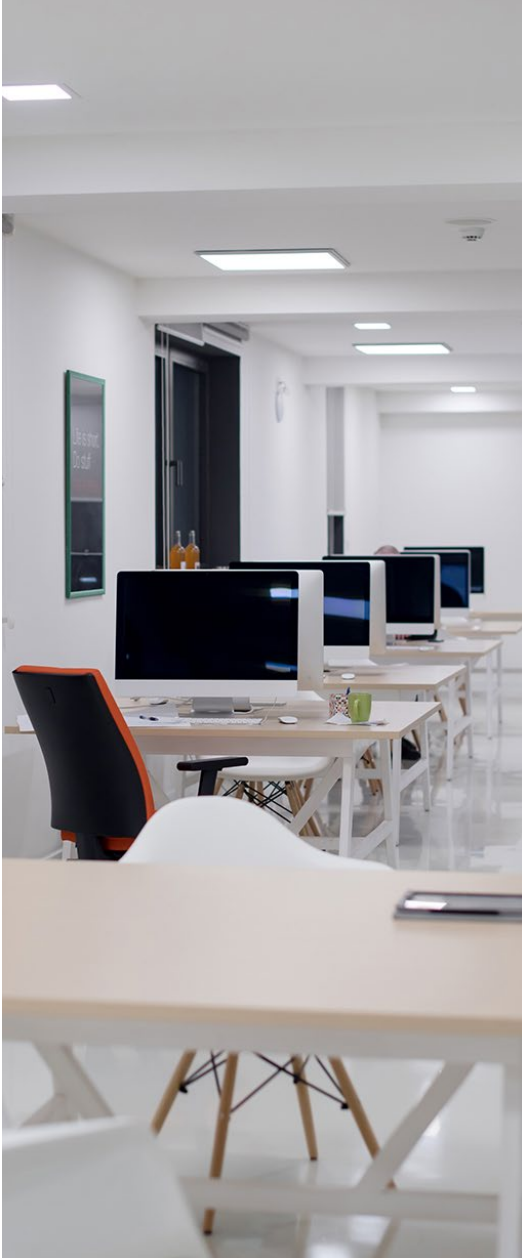

Requirements for LED office lighting

The European lighting standard DIN EN 12464-1 regulates how the working environment in an office must be illuminated. The quality of light is measured and defined by different quality characteristics conforming to standards. If these are fulfilled, the result of a good LED lighting concept is achieved.

Visual Performance:

- Glare-free vision (neither direct nor reflected glare)
- enough brightness (lighting level)

Visual comfort:

- Light color and color rendering influence the mood of the room and thus also that of the employees (motivating, vitalising etc.)
- A balanced relationship between luminaires, room size and architecture determines the distribution of brightness in the office.

Visual Ambience:

- Light color, light direction and the interplay of light and shadow (modelling - this creates the three-dimensional effect of objects in the room -> important for orientation in the room) create the atmospheric ambience in which employees should spend time and feel comfortable.

Further quality characteristics to be taken into account are

- Energy efficiency
- Daylight integration
- Individual setting options
- Lighting situation change

Minimum illuminance at the workplace in the office

In accordance with the DIN EN 12464-1 standard, office workplaces must be illuminated with at least 500 lux, and in some sectors with special visual tasks even with at least 750 lux (e.g. in the sector of monitors).

The requirements for the perimeter and surrounding areas of an office are much lower. Here, 300 lux is enough to comply with the standard.

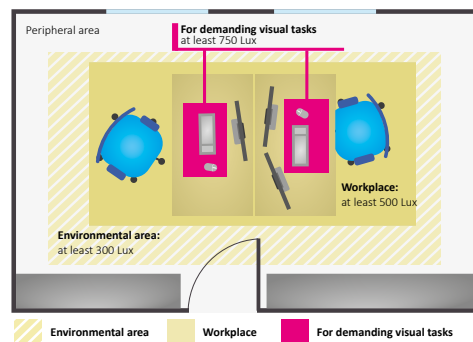



Up to 80 % cost reduction

Fast amortization of investments made and strong cost reduction (with LED illuminants from ISOLED® up to 80 % cost saving compared to traditional illuminants) immediately relieve the running operating costs.

Transparency of your investment costs with a payback calculation from ISOLED® is possible at any time.

We are looking forward to your inquiry!

Why LED?

ALL ADVANTAGES AT A GLANCE



LED ARE ENERGY AND COST EFFICIENT



WATERPROOF LEDS



LEDS PRODUCE LIGHT IMMEDIATELY



LED INVESTMENT WITH FAST AMORTIZATION!

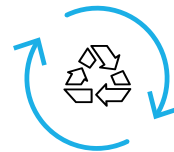

LEDS ARE NOT HAZARDOUS WASTE



LED ARE ROBUST AND INSENSITIVE



CONTINUOUSLY ADJUSTABLE

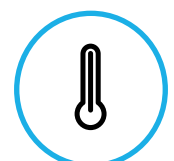

LOW HEAT EMISSION

PRODUCT RANGE

CUSTOMISED LIGHT SOLUTIONS

ECONOMICALLY VALUABLE | ECOLOGICALLY SENSIBLE

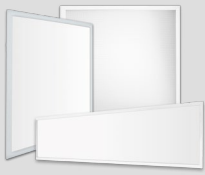

LED panels



LED tubes and
diffuser luminaires



LED Pendant and
Floor lamps



Modular and
configurable LED light
line systems



LED downlights



LED emergency
light/escape route
luminaires

#1



**COMPETENT
CUSTOMER SERVICE**

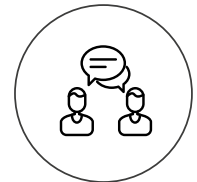

**PERSONAL
SERVICE**



3.050
LED items

439 NEW
Quality products

1.200 Pages
full of highlights!



ISOLED® Catalog
exclusively for our partners online
and as a high quality print version

Annual catalog with
1200 sides in 5 languages
(35,000 pcs./circulation)





High-end LED technology Glare-free, activating and vitalising - For a perfect visual ambience

LED PANELS



HCL Line Panels RGB+W/
CCT UGR>19



BACKLIGHT LINE Panels
CRI>90

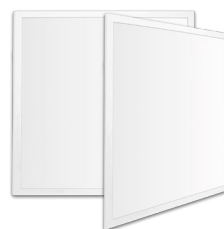

ECO LINE panels



Business LINE panels



PROFESSIONAL LINE
Panels

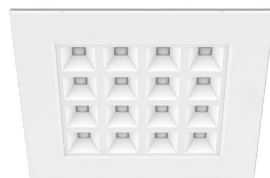

UGR <16 LINE panels

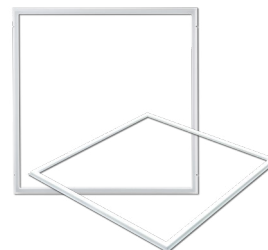

DECO panels



Accessories for panel
Installation

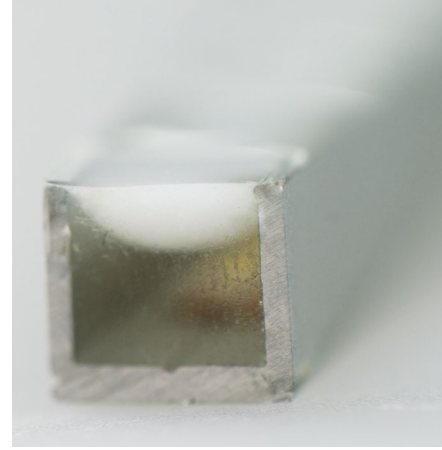

CUSTOMISED ASSEMBLY

Focus your efforts on your core competences.

WE TAKE OVER THE PROFESSIONAL MANUFACTURING!

We are a customer-oriented company and, in addition to our extensive product range, offer services with sustainable added value. This includes, among other things, the professional assembly of light building elements with LED flex stripes, LED aluminum profiles and their additional components, which we are happy to take over for you.

Competent and reliable according to custom requirements!

You save valuable working time!

You can immediately start with the installation!

You have the certainty that your LED lighting will work reliably!

We advise you.

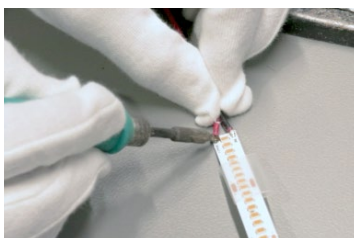

Assembly of LED flex stripes

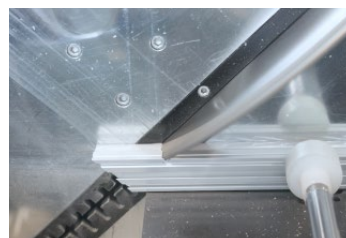

Assembly of LED profiles

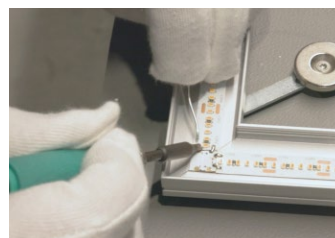

Merging LED flex stripes and aluminum profiles

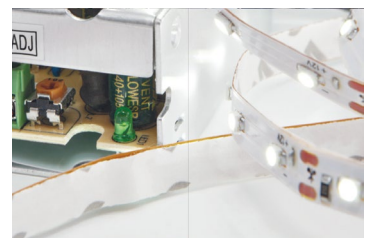

Wiring with LED technology

Manufactured light elements
Precise manufacturing
Delivery ready for installation

PRECISE - FAST - RELIABLE





Homogenous lighting solutions with powerful Highend-LED-Technology

LED TUBES AND DIFFUSER LUMINAIRES



LED tubes KVG compatible



LED tubes with cable



Diffuser luminaires



THE RIGHT LIGHTING FOR A PROFESSIONAL WORKING ENVIRONMENT

LED PENDANT AND FLOOR LAMPS





THE MODULAR LIGHT LINE SYSTEMS
OPEN UP COUNTLESS DESIGN OPTIONS
FOR INDIVIDUAL LIGHTING DESIGN.

MODULAR AND CONFIGURABLE LED LIGHT LINE SYSTEM





DISCOVER THE ISOLED® PRODUCT WORLDS

**You want to know what Skyblue is all about?
Or how best to showcase a modular light?**

Find technical knowledge about the product and a wealth of inspiration. We also have the perfect application for your modular luminaire. We can also configure your dream light entirely according to your wishes.



LED EMERGENCY LIGHT/ ESCAPE ROUTE LUMINAIRES

Safety in case of emergency

In the event of a power failure or disturbance of the general power supply or lighting system, adequate lighting (emergency lighting) must be provided to ensure safe exit from the building or to avoid panic.

European standard for labelling

The legal requirements regarding lighting requirements and marking of escape and rescue routes are regulated in the European standards EN 50172:2005 and EN 1838:2019.

Recommendation for planning

To plan an emergency lighting system in your building, we recommend that you consult an expert in the field. We would be happy to put you in touch with a partner in your area.



**EMERGENCY LIGHT
OPERATION 3 HOURS**

LED panels and Linear-Diffuser luminaires with Battery Pack

ISOLED® Luminaires with integrated rechargeable battery pack (see page 85 Battery module for LED panels and page 109 Pro-fessional Linear-Diffuser luminaire) ensure basic lighting in of-fices, workshops, basements and underground car parks in the event of a power failure, even without an emergency power supply unit or central battery system.

New in the range UNI4 and UNI7 emergency light/escape route luminaires conforming to standards

With our two emergency light/escape route luminaires UNI4 and UNI7, which have a recognition range of 20 and 18 meters respectively and four adhesive escape signs (up/down/left/right arrows), you can implement the marking and signage of escape and rescue routes safely and in accordance to standards.

Integrated battery for 3 hours emergency operation

The UNI4 LED light is equipped with a 1.500 mAh Ni-cd battery and the UNI7 with a 1.900 mAh battery, which allows a battery operation for more than 3 hours in case of power failure (charging time approx. 24h).

If the power supply is maintained, a switched continuous operation is optionally possible.

Automated self-tests replace manual function checks









After the initial installation, the luminaires carry out a self-test, a function test once a week and a long-term test 36 hours after the initial installation and once a year. The periodically prescribed and time-consuming manual function checks are therefore no longer necessary.

Note on the operation display

Manual tests can be initialized at any time by pressing the integrated test button. Correct operation is indicated by a green signal LED, errors by a red signal LED.

Guidelines for emergency light/escape route luminaires

Basically, the following applies to emergency lights and escape route luminaires etc:

-  **Placement at least 2m above the ground** (visible from both sides)
-  **Distance <2m for each exit door to be used in an emergency**
-  **Distance <2m for every stair, height or direction change**
-  **Escape signs must be illuminated in the event of a power failure**
-  **Distance <2m at any first aid kit or fire alarm point**
-  **The minimum lighting intensity on escape and rescue routes is 1 lux on the ground,**
-  **where the ratio of maximum to minimum lighting intensity must be <40:1.**
-  **(At machines or places with special hazards 15lx at light median <10:1**

Note on planning emergency lighting systems

When planning an emergency lighting system, we recommend consulting an expert in this field who can guarantee compliance with all European standards.



Quality, range and timeless designs
System solutions for individualists

LED RECESSED LIGHTS - DOWNLIGHTS



Variable
Hole cutout



Round
Hole cutout

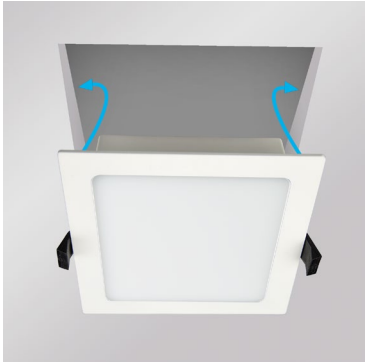

Square
Hole cutout





ISOLED® TECHNOLOGY

On the pulse of progress

Driven forward by the innovative power of our specialist team as well as the increasing demands for our customers and the market, taking into account the latest technologies, we develop and design much improved and completely new LED components, products and lighting systems.

Unique through customised

In close cooperation and intensive exchange of our product management team with the production side research & development team, trendsetting, solution oriented and custom lighting concepts with the highest economic and environmental energy efficiency arise.



Our customers and partners benefit consistently from quality, functionality and efficiency.

Sustainable Performance Values and Stable Light Quality

- High energy-efficient light output
- Exact binning
- High-end LED chips, PCBs & Components
- Standardised electronics Excellent product grades
- Reliable thermal management
- Tested materials

Modern ISOLED® lighting laboratory

- Multistagequality control
- Batch-managed material flow
- Quality management & warranty services
- Internal & external Quality audits
- Customer-oriented return management
- CE certification

Visionary Innovation

- Product Development
- Intelligent Product Design
- Compact Construction
- Precision Manufacturing Processes
- Latest LED Technology
- Strict Quality Criteria

YOUR PARTNER

ISOLED SINCE 2008

Licensed partnerships

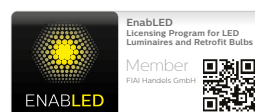

SIGNIFY = PHILIPS

LUX - The indicator for good LED lighting at the workplace

SI unit*: Lux (lx)

CALCULATION: $\frac{\text{Luminous flux (lm)}}{\text{Area (m}^2\text{)}} = \text{illuminance (lx)}$

The illuminance indicates how much luminous flux is incident on a defined area and is thus calculated from the quotient of the luminous flux (lm) by the illuminated area (m²).

The illuminance developed by a light source on a surface decreases with increasing distance squared.

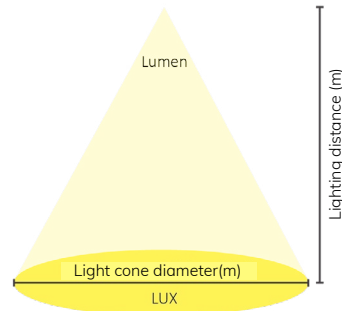

Illuminance levels Workplace Ordinance

DEMANDS ON THE VISUAL TASK	NOMINAL ILLUMINANCE LEVELS	EXAMPLE
extremely low	50 lx	Storerooms, storage rooms
low	100 lx	Break rooms, traffic zones
low	150 lx	Traffic zones with vehicles, loading areas
moderate	200 - 300 lx	Work on the workbench, machine tools, rough work, reception counters Hotel
medium	500 lx	Office
high	750 - 1000 lx	Techn. Drawing, precision mechanics, printing
particularly high	1500 lx	Watchmaker's workshop, electronics workshop
extraordinary	2000 lx	Engraving, artificial stopper

* Definition SI: SI is the international system of units for physical quantities.

DIN EN 12464-1: Recommended minimum requirements for lighting in offices

Type of room, activity and visual task	Illuminance on the surface of the visual task in lux	UGR limit value (limitation of direct glare)	Ra (color rendering index of the illuminant)
File and copy	300	19	80
**Writing, reading, electr. Data processing	500	19	80
**Technical drawing	750	16	80
**CAD workstations	500	19	80
Conference and meeting rooms	500	19	80
Reception area	300	22	80
Archives	200	25	80

** For VDU work, further requirements apply according to DIN EN 12464



UGR Unified Glare Rating

The internationally standardized UGR method (Unified Glare Rating) is used for the uniform assessment of psychological glare caused by lighting systems, natural light and light sources from reflective surfaces at the workplace. The European standard EN 12464 describes which UGR limit values must be complied with for certain visual tasks in different work areas.

Direct glare and indirect or reflected glare are included in the calculation of the UGR value. Direct glare is caused by natural and artificial light sources; indirect glare, on the other hand, is the reflection of light from e.g. monitors, large walls, ceilings, glass surfaces, furniture etc. and therefore also contributes to the impression of glare.

UGR limit values (UGR)	
(complete listing of all UGR limit values for activities and visual tasks are specified in the EN 12464 standard)	
Technical drawing	≤ 16
Working on the PC, reading and writing, school facilities	≤ 19
Craft and industry	≤ 22
Halls	≤ 28

Direct and indirect glare affect

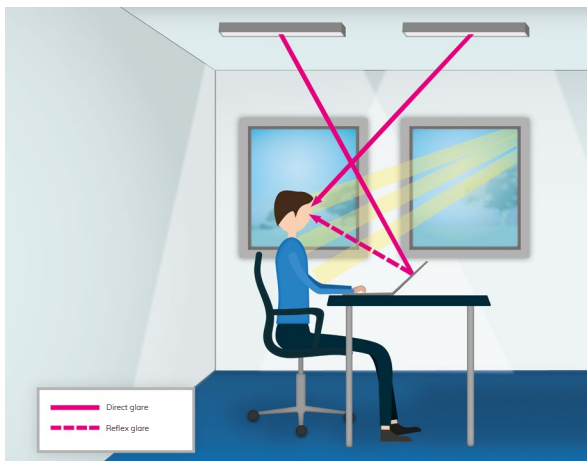

Direct glare from non-glare-free luminaires and unimpeded solar irradiation strain vision and lead to fatigue. Concentration wanes and the risk of making more mistakes increases. Physical work is made more difficult by the elevated risk of accidents. For this reason, it is necessary to use luminaires with an appropriate glare factor, install sun protection on windows and also redesign the position of work areas in the room. Indirect lighting,

UGR-optimised lighting promotes

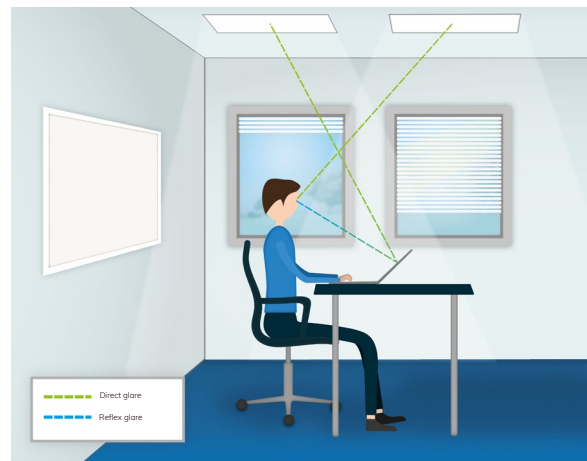

mat fixtures with low light reflection, work surface layouts adapted to the light sources and the avoidance of reflective surfaces prevent stressful **reflected glare**. Concentration is maintained for longer and leads to high productivity.

Sustainable increase in efficiency with daylight and motion sensors



Demand-responsive lighting - energy savings of up to 80%

Intelligent LED lighting solutions from ISOLED® reduce power consumption while maintaining the same quality of light by using energy-efficient LED lighting components and light sources

- targeted to meet the demand,
- the architectural framework conditions as well as
- the availability of natural light

will be voted on.

The intelligent use of light with a holistic LED lighting concept reduces energy consumption by up to 80 %. Motion and brightness sensors monitor the room and detect when and how much light needs to be produced in the room to reach the preset brightness level based on motion by a person and the amount of daylight entering the room. The LED lights are switched on, dimmed or switched off.

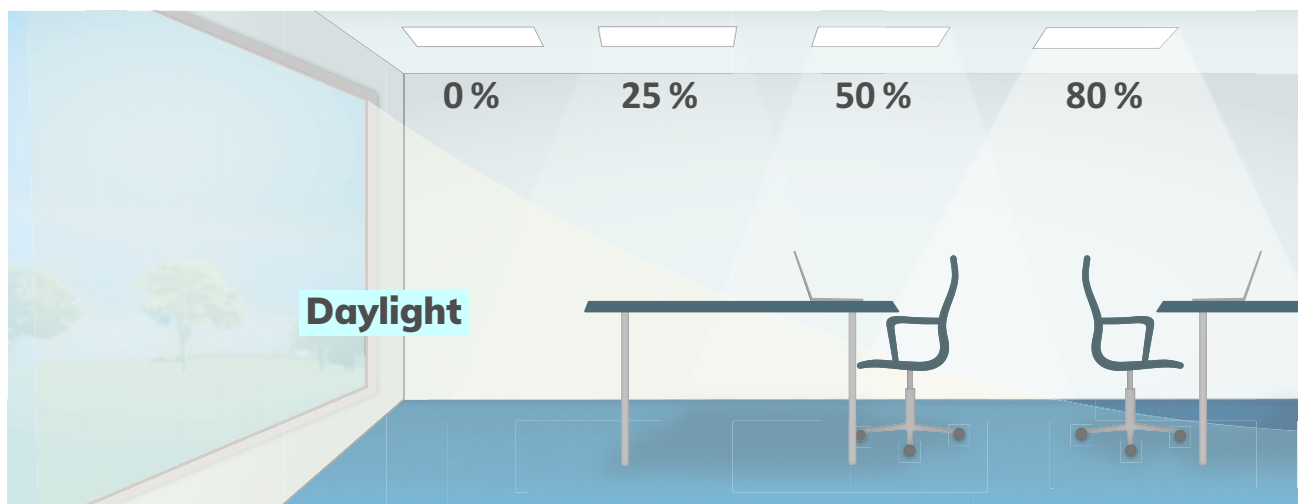

Significant cost reduction with unchanged lighting quality

Daylight-dependent lighting control systems use light sensors to detect the lighting intensity of natural daylight (which enters through windows) and regulate the amount of light in the room according to the preset setpoint values.

Lights are switched on and off or dimmed depending on their position in the room.

Benefits:

- Light always adapted to the visual tasks
- Immediate electricity savings





PRODUCT QUALITY AND DESIGN

SUSTAINABLE QUALITY

Your quality requirements are our touchstone

For our customers and partners, we undertake to sustainably supply lights, lighting construction elements and systems, control equipment based on the latest LED technology, as well as all services in

- best and guaranteed quality,
- with the greatest possible ecological efficiency as well as
- economic stability of value

sustainably.



ISOLED® Data sheets

Real performance data measured under real conditions are published in a data sheet for each item. Every customer has direct online download access.



Sustainable quality and operational safety

The complete LED ISOLED® product range is CE-marked and therefore complies with the requirements for product conformity according to the latest EU guidelines.

A tested and certified CE-product coordinator from ISOLED® takes over the execution of all ongoing internal standardisation and counter-checks of the EU directives. Supplier audits ensure compliance with the CE requirements by the manufacturer.



The heart of our light laboratory are the two ulbricht spheres (diameter 0.5 m and 1.7 m), which are used to measure photometric data.

Trust through data transparency

REAL PERFORMANCE DATA

The satisfaction of our customers and partners is achieved through data transparency. As part of a regimented multi-stage quality control programme, we test and measure all photometric parameters and in addition to numerous additional details, include these within our product datasheets.

Our specified performance data are NOT the result of physical or theoretical calculations, but they correspond to the photometric values of the final overall product actually measured in our in-house light laboratory. (I.e. including reflectors, optics, housing - measured under real ambient conditions, etc.)

On request, we can of course also provide specific reports from our photometric test laboratory.



Whether it is a new acquisition or a conversion to LEDs, both cases are long-term investments. Against this background, it is of particular importance to consider the following quality features in the decision-making process:

- Materials of the individual components (e.g. aluminium housing)
- Glasses and covers
- High-quality workmanship (pay attention to seams and connecting pieces - small proportion of load-bearing plastic elements)
- High quality lacquers
- TÜV certification
- Protection class IP (dust and water protection)
- D-marking acc. EN 60598-24 (LED lights suitable for use in fire-endangered locations)
- Glare factor (UGR acc. EN 12464)
- Timeless and architecturally integrating aesthetics

Your quality standard is our touchstone!

The matching LED illuminants are of tested quality and designed for commercial use. LED branded products from ISOLED® consist exclusively of high quality components that are manufactured with selected materials in modern and innovative production processes. Only tested LED chips and standardised components (excellent quality classes) are used.

They convince with their performance values:

- service life
- Light quality
- Luminous flux
- Light intensity
- Color rendering
- Color temperature
- Connected load
- Heat generation (cooling) etc.

LED chips and components of the highest quality classes

LED branded products from ISOLED® consist exclusively of high-quality components, which are manufactured in selected materials in modern and innovative production processes.

Only tested LED chips and standardised components (excellent quality) are used. Our LED products must meet the prescribed performance values in accordance with the strictest quality and test criteria without any complaints in order to be finally released for sale.

ADVANTAGE THROUGH KNOW-HOW

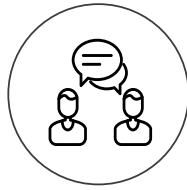

Improving consultancy skills

We combine many years of experience in technical application areas with LED know-how and pass both on to our employees.

With a deep understanding of the economic and environmental efficiency of LED light solutions, as well as enthusiasm for this sustainable and environmentally friendly type of lighting, they support our customers and partners through each LED project.

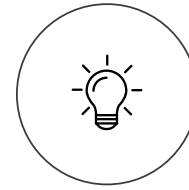

Specific customer training

We have a major interest, in training you and your employees in the topics of

- ISOLED® Product knowledge,
- ISOLED® application technology,
- LED basic knowledge and
- LED sales

for basic training and further development.

„Confidence comes with knowledge, this is why we share our expertise!“

ISOLED® Team

ISOLED® ACADEMY

TAKE ADVANTAGE OF OUR OFFER

We offer **onsite and offsite training**. Whether in-house, by phone or webinar - you and your employees will receive all information and documents from us.

- » LED know-how
 - LED technology basics
 - ISOLED® product training
 - ISOLED® workshops for LED application technology
 - ISOLED® Workshop “Lighting design with DIALux”
 - Customer-specific LED workshops

- » ISOLED® sales support for customers, partners and their staff
 - LED starter support for trade and crafts
 - Target group definition/market approach - How to reach your target customers (ISOLED® industry focus)!
 - 100% LED - targeted argumentation with facts. With knowledge you score points with customers!
 - 100 % ISOLED® - this is how you and your customers benefit from the ISOLED® range of services!
 - Customer-specific ISOLED® workshops

We would be happy to create your personal training program tailored to your team!

Please contact us and book your individual workshop!

ACADEMY





MORE THAN "JUST A WEB-SHOP"

In our extensive online portal you will find everything your "LED heart" desires. Whether knowledge, training or video instructions - we provide you with all the materials and services that you or your customers need.

KNOWLEDGE



ADVANTAGE THROUGH KNOW-HOW. WE SHARE OUR KNOWLEDGE!

Bundled knowledge on important topics from LED technology as well as application-specific assistance and instructions.

INDUSTRY FOCUS

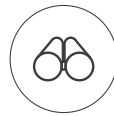

YOUR ASSISTANT FOR ACHIEVING JUST THE RIGHT APPEAL FOR YOUR BUSINESS!

We support you in your target group-oriented market approach with our ISOLED® sector focus.

PRODUCT WORLD



ALWAYS THE RIGHT LIGHT FOR YOUR APPLICATION!

Over 3,050 high-quality LED branded items and numerous new products.



ISOLED® download area

- » Product documentation
- » Instructions
- » Product specifications in digital form
- » Light calculation files
- » CE declarations of conformity
- » Print version of our product catalog
- » ISOLED® Product knowledge
- » ISOLED® application technology
- » LED basic knowledge
- » LED initial assistance for sales





THE NEW PRODUCT CATALOGUE COLLECTION ISOLED® 2024

All good things come in fours! For a targeted customer approach, our new collection of ISOLED® 2024 product catalogs is divided into four issues. This means that you always have the right catalog with the appropriate product groups at hand. In the spirit of sustainability, you can of course also browse through all catalogs online.

Four topic-specific Catalogs

- » 1200 pages full of highlights
- » Available in: DE, EN, FR, IT & HU
- » Online flip catalog and up valuable print version
- » Prefabricated lighting components
- » Individual lighting concepts
- » Sustainable, intelligent lighting solutions
- » Custom-made products and OEM production

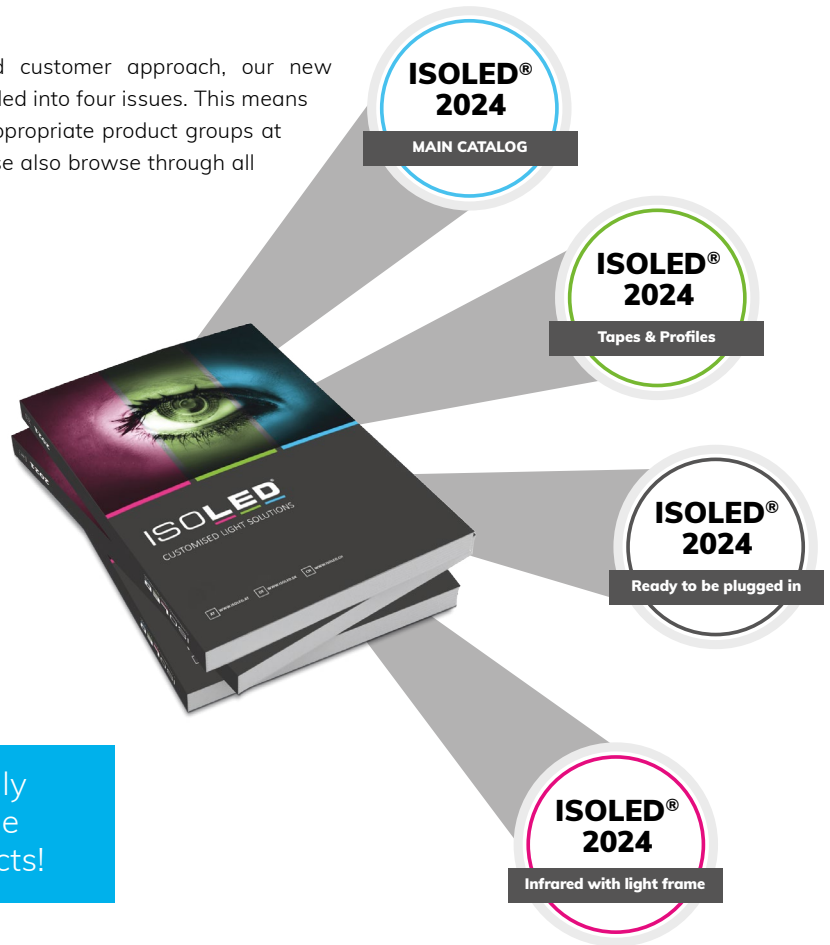

We advise you personally and support you with the realisation of your projects!

DISCOVER ISOLED® ON YOUTUBE

Want to know what the United Glare Rating is all about? Or how to professionally install a drywall profile?





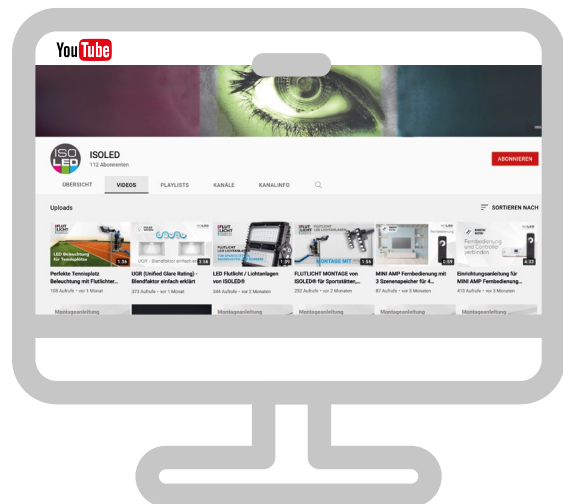







On our new YouTube channel you will find a constantly growing collection of videos on assembly instructions, product worlds, practical applications and knowledge topics.

YouTube VIDEOS ON ALL LED TOPICS



ISOLED® ONLINE PORTAL

ALL BENEFITS AT A GLANCE

-  Discount classification and terms and conditions agreement with our sales staff
-  complete product documentation for free download approved
-  Offer submission for project inquiries through our Inside / outside sales
-  contact person at ISOLED®(Inside / outside sales)
-  free, easy and unbureaucratic registration
-  unrestricted access to Light calculation files
-  ordered by 11 a.m., usually dispatched the same day
-  continuously secure connection to the ISOLED® online portal high security standards
-  Current product availability can be called up in real time High product availability
-  free online and offline version of the ISOLED® catalog
-  direct order entry Order history can be called up at any time
-  Status overview and online Tracking of completed orders

ISOLED® INFOMAIL

SUBSCRIBE WITHOUT OBLIGATION AND CANCEL AT ANY TIME

With the ISOLED® Infomail and you will benefit immediately from our special offers, LED product news and many interesting facts from the world of LED technology.



INFOMAIL

Log In

Become a partner today and register NOW!





Product catalog ISOLED®

- » 1200 pages full of highlights
- » 35.000 pieces Circulation
- » Available in: DE, EN, FR, IT & HU
- » Online flip catalog and high-quality print version

Choose from over 3.050 items!

- » Innovative LED brand products
- » Over 100 product categories
- » Sustainable, intelligent lighting solutions
- » Individual lighting concepts
- » Manufactured light elements
- » Special designs and OEM production

We advise you personally and support you in the realisation of your projects!

AT WWW.ISOLED.AT **DE** WWW.ISOLED.DE **CH** WWW.ISOLED.CH

Legal notice / Photo credits: All rights reserved by ISOLED® FIAI Handels GmbH.

Imprint: This catalog is published by ISOLED® FIAI Handels GmbH in Egerbach 48, A-6334 Schwoich, AUSTRIA | produced and published.

Company register number FN304126w | UID number: ATU63995500

Please note that we use all products and services exclusively **according to our terms and conditions and warranty conditions** to offer. You can download it from our homepage.

Datasheets and other technical information can be found on our homepage at www.isoled.at / www.isoled.de / www.isoled.ch / www.isoled.it / www.isoled.fr.

Please note: The technical information in this catalog is correct at the time of printing and has been determined to the best of our knowledge. Nevertheless we reserve the right to errors and misprints. The information is used to provide a more detailed description of the item, but are not guaranteed properties if they are not expressly designated as such. / The items in this catalog can be removed from the ISOLED® product range at any time without replacement. / We reserve the right to make changes in favor of technical progress or to adapt to changed standards or regulations. / Photos and drawings in this catalog are exemplary embodiments and are not binding for the execution of the delivery. / ISOLED® FIAI Handels GmbH is not liable for any unavailability of the catalogue products. / ISOLED® FIAI Handels GmbH is also not liable for any direct, indirect, incidental or other damages (including, but not limited to, lost profits, lost revenues or similar economic damages) arising out of the use of information contained in this catalog. / A violation of property rights or the use of text and layout design (including photos) without our approval are not permitted and will be prosecuted. / The presentation of our products is made possible by the courtesy and consent of the owners of the surroundings that can be seen superficially in the pictures. We want to express our thanks for this.

Version 2102/2024

ISOLED® AUSTRIA Technology and Logistics Center

ISOLED® FIAI Handels GmbH | Egerbach 48 | A-6334 Schwoich | Tel: +43 5372 219999 | E-Mail: office@isoled.at

ISOLED® AUSTRIA
www.isoled.at

ISOLED® GERMANY
www.isoled.de

ISOLED® SWITZERLAND
www.isoled.ch

ISOLED® FRANCE
www.isoled.fr

ISOLED® ITALIA
www.isoled.it

ISOLED® HUNGARIA
www.isoled.hu

YOUR PARTNER

ISOLED[®] SINCE 2008



ISOLED[®] AUSTRIA
ISOLED[®] FIAI Handels GmbH
Egerbach 48
A-6334 SCHWOICH
AUSTRIA

Tel: +43 5372 219 999

E-Mail: office@isoled.at
www.isoled.at



ISOLED[®] GERMANY
FIAI Trading GmbH
Hollerweg 3
D-85649 BRUNNTHAL
GERMANY

Tel: +49 810 48 999 200

E-Mail: office@isoled.de
www.isoled.de



ISOLED[®] SWITZERLAND
Allegra Swiss GmbH
Einsiedlerstraße 15a
CH-8834 SCHINDELLEGI
SWITZERLAND

Tel: +41 44 787 04 75

E-Mail: info@isoled.ch
www.isoled.ch

99,3 %

**of our customers and partners
recommend ISOLED[®] !**

YOUR DEMAND IS OUR MOTIVATION!